



**MULTISTRADA 1200 &
1260 ENDURO 2018-2020**

FITTING INSTRUCTIONS

TO BE FITTED BY A QUALIFIED TECHNICIAN



SECONDARY WATER PUMP COVER – PART NO. EC-937-2016-5-GBR

- 1 Remove fairing.
- 2 Remove 3 existing bolts from the water pump cover, shown as position Bolt 1, 2 & 3.
- 3 Place the secondary water pump cover over the stock cover.
- 4 Assemble 3 replacement bolts loosely in the correct position as shown.
- 5 Tighten bolts to a Torque of 10Nm as per Manufacturer's recommendations.
DO NOT OVERTIGHTEN.
- 6 Re-fit fairing.

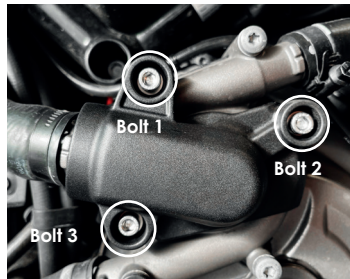

**Bolt 1-SPB2
M6X40A2-
10Nm (max)**

**Bolt 2-SPB2
M6X40A2-
10Nm (max)**

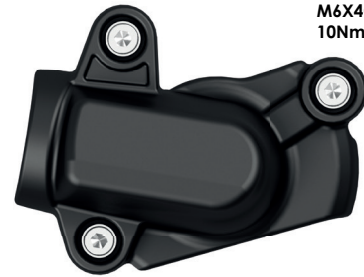

**Bolt 3 -SPB2
M6X40A2
- 10Nm (max)**